

USE THE SELECTION GUIDE BELOW TO DESIGN YOUR OUTDOOR KITCHEN

Selection Guide:

- Specify barbeque frame size:
2 burner, 3 burner, 4 burner,
5 burner.
- Specify fuel and connection:
LPG Cylinder, LPG Bayonet, Natural
Gas Bayonet or Charcoal.
- Specify stainless plate and grill
combination from range of
sizes. See website for details.
- Specify flat lift-away SS lid or
roasting hood with/without
ceramic glass viewing window.
- Specify cabinet kit under barbeque, two drawer.
- Specify cabinets to each side (identify left or right hand side for each cabinet
selected).
- Specify adjustable stainless steel legs or structural stainless steel plinth.
- Where there are two or more adjacent cabinets select a single seamless benchtop
spanning multiple cabinets.
- Are one or both end panels visible? If so then add stainless steel or stone end panels.
- Will the outdoor kitchen be open at the rear? If so then add Colorbond or Stainless
Steel rear void cover panels
- Will a 150mm Stone splashback be required?

Note: We can build to suit your site. Just email us a picture of the available space with the dimensions and a list of the features you'd like included and we'll get back to you with a quote.

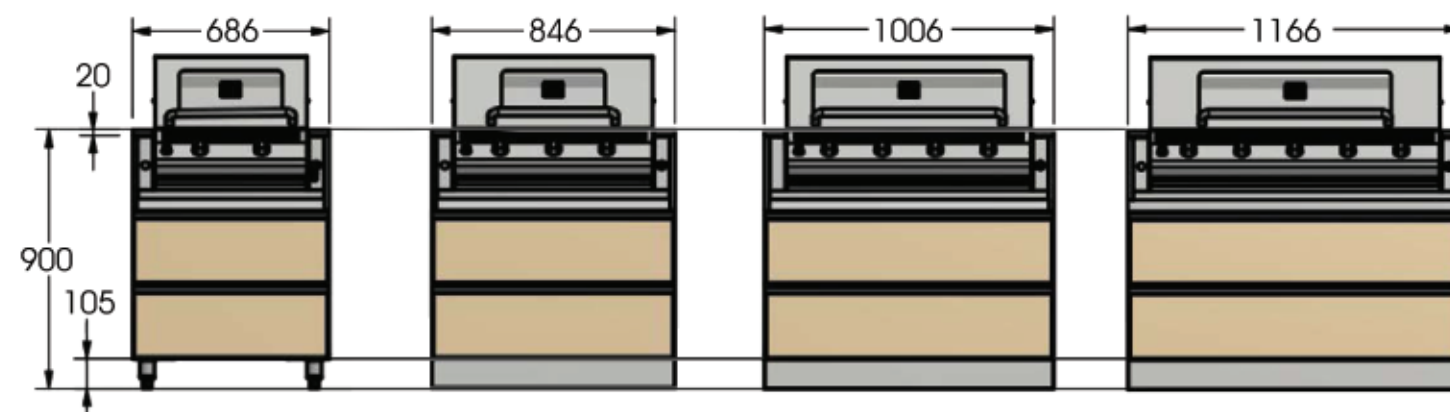
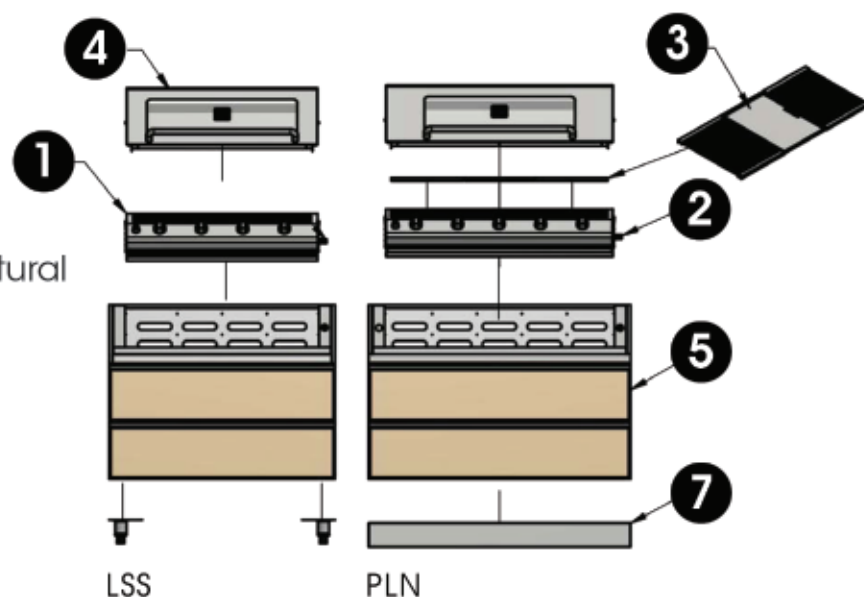

Note: you can select multiple BBQs in your outdoor kitchen in different sizes and also a Gas and separate Charcoal BBQ.

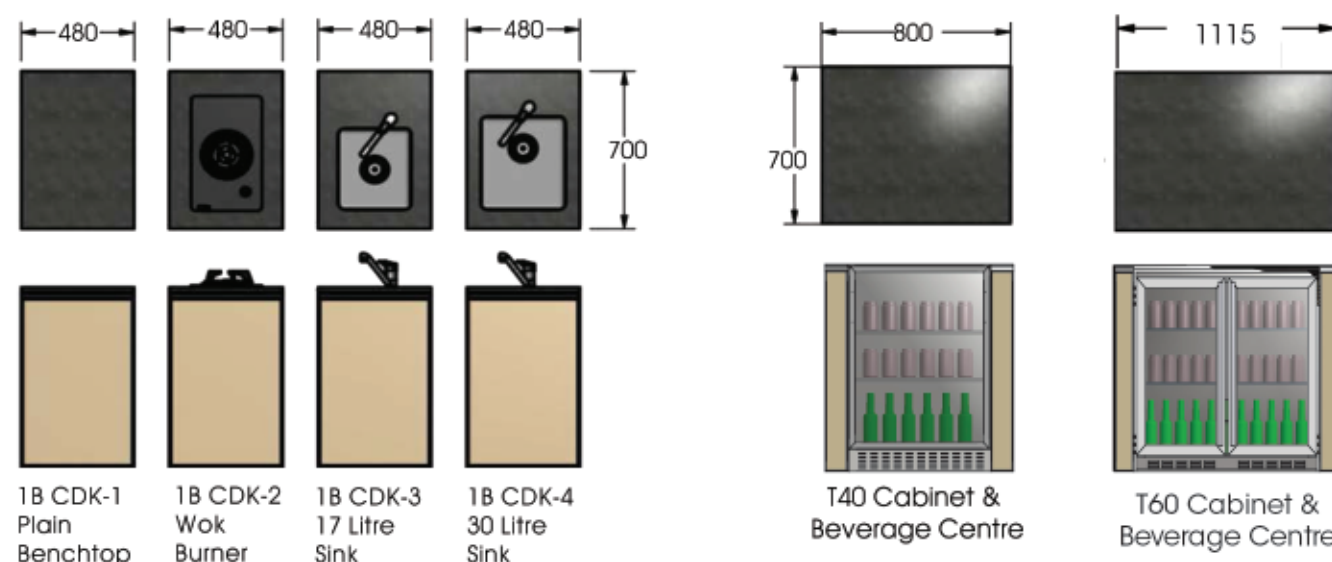

Note: A corner cabinet is available for L-shaped kitchens, add a 3B CDK-0 Dimensions = 725mm x 725mm

